

# The Everton



Artist's impression only

**49 Walker Drive, Drouin** - LAND SIZE 770m2  
4 Bedroom, Rumpus & Garage 21.2 squares

**House & Land  
\$364,900\***

## North Facing Rear Views

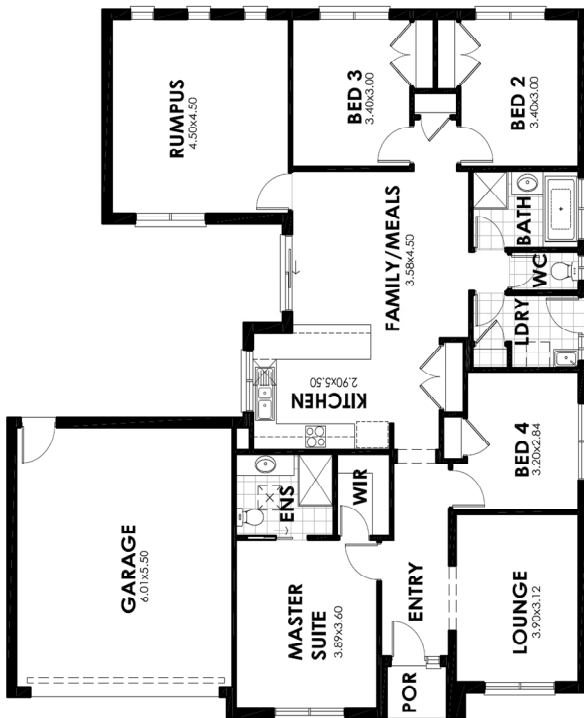

### Inclusions:

- Stanfield Façade,
- On Stumps with Timber Sheeting Floor
- Colorbond Roof
- Colorbond Fascia & Gutter
- Gas Ducted Heating
- 2400mm Ceilings
- Flick Mixer Taps to Kitchen, Bath, Showers, Laundry & Vanity Basins
- 600mm Stainless Steel Electric Fan Forced Oven
- 900mm Stainless Steel Gas Hot Plates
- 900mm Stainless Steel Rangehood
- Dishwasher Provision
- Aluminium Lockable Windows
- (Awning to front elevation, Sliding to remainder)
- Flyscreens to all opening windows
- Carpets
- Floor & Wall Tiles to Wet Areas
- 1200mm x 900mm tiled shower base to Ensuite
- Double Vanity to Ensuite
- Remote Panel lift door to garage
- Solar Hot Water Service with Gas Instantaneous Booster
- Plain Concrete Driveway & Path Allowance
- NO Country surcharge

\*\*\* Subject to soil test and levels

Please call Peter Konjevic 0418 515 755  
or Zac Jeric 0428 759 015  
Barry Plant Real Estate

**red bluff homes**  
SMART BY DESIGN

DISPLAY HOMES 'THE NEWHILL' & 'THE ASTON' - WATERFORD RISE ESTATE - 10 & 12 HILLGROVE CLOSE, WARRAGUL